

CITY OF
WOLVERHAMPTON
COUNCIL

Cabinet (Resources) Panel

Wednesday, 6 July 2022

Dear Councillor

CABINET (RESOURCES) PANEL - WEDNESDAY, 6TH JULY, 2022

I am now able to enclose, for consideration at the Cabinet (Resources) Panel meeting on Wednesday, 6th July, 2022, updated scheme drawings for the following report.

Agenda No Item

- | | |
|---|--|
| 5 | Noose Lane to School Street Active Travel Route (Pages 3 - 6)
[To approve the Noose Lane to School Street active travel project] |
|---|--|

If you have any queries about this meeting, please contact the democratic support team:

Contact Dereck Francis

Tel 01902 555835

Email dereck.francis@wolverhampton.gov.uk

Address Democratic Support, Civic Centre, 1st floor, St Peter's Square,
Wolverhampton WV1 1RL

Encs

This page is intentionally left blank

Reproduced from Ordnance Survey digital map data
 © Crown copyright and database rights 2021
 Ordnance Survey 0100031673

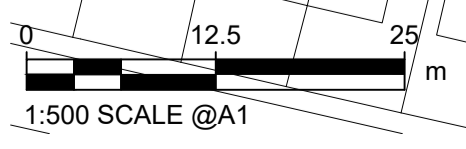
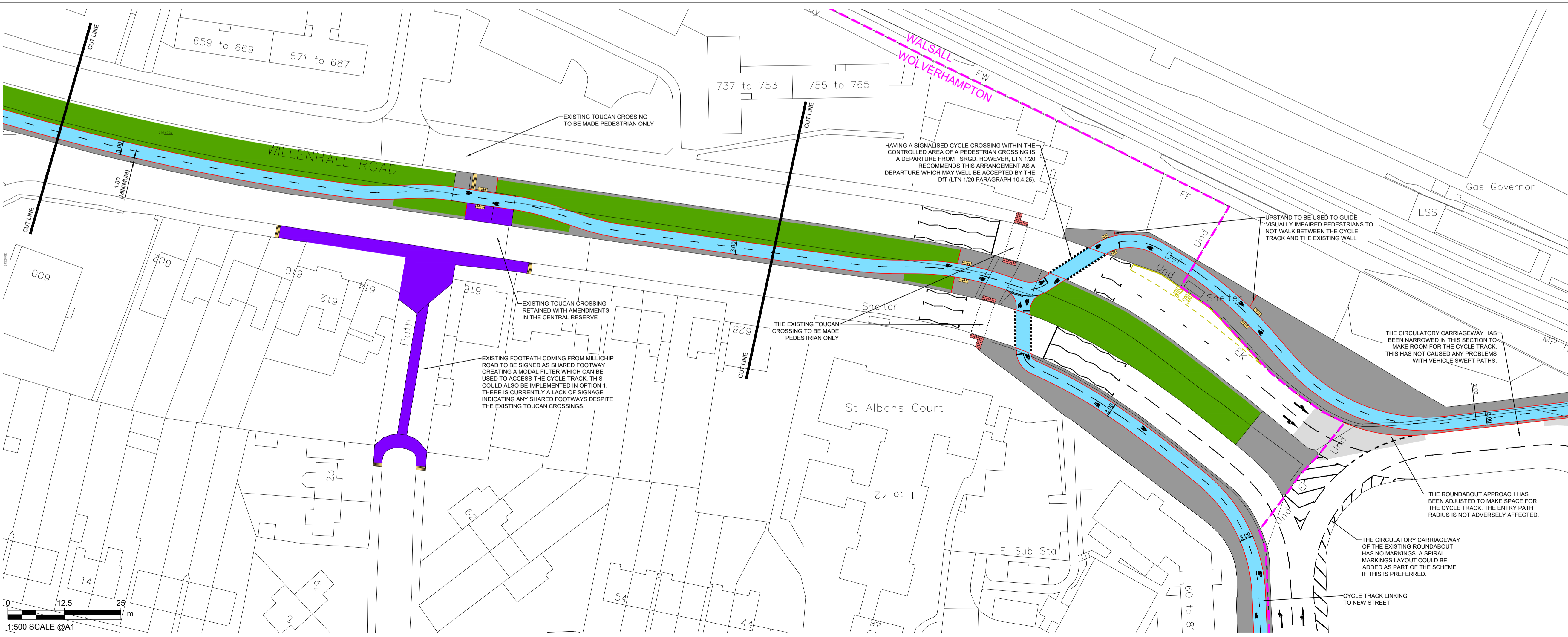
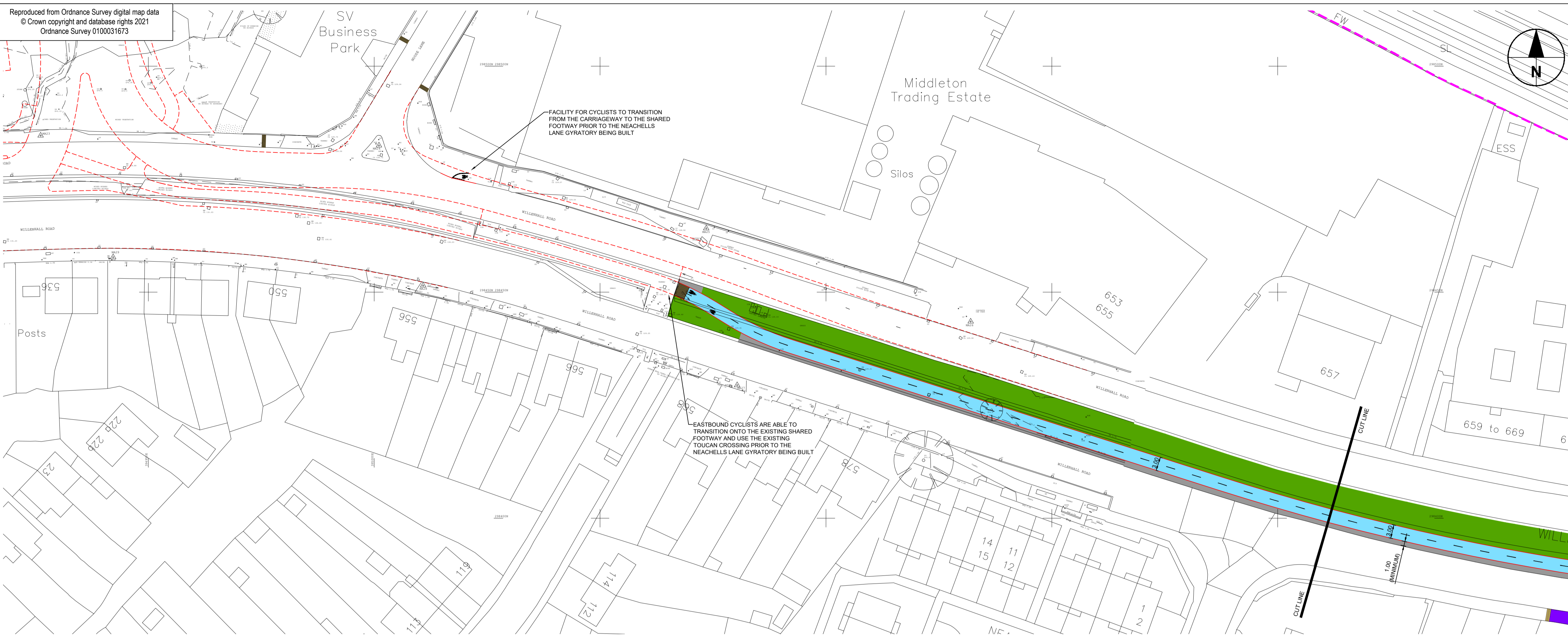

This drawing has been prepared for the use of AECOM's client. It may not be used, modified, reproduced or relied upon by third parties, except as agreed by AECOM or as required by law. AECOM accepts no responsibility, and denies any liability, whatsoever, to any party that uses or relies on this drawing without AECOM's express written consent. Do not scale this document. All measurements must be obtained from the stated dimensions.

- NOTES**
- FOR KEY LOCATION PLAN, REFER TO DRAWING 60640382/SK/05.
 - ALL DIMENSIONS ARE IN METRES.
 - THE PROPOSED DESIGN IN WALSALL COUNCIL'S LOCAL AUTHORITY DISTRICT IS FOR ILLUSTRATIVE PURPOSES ONLY AND IS SUBJECT TO WALSALL COUNCIL'S CONSIDERATION AND APPROVALS.

- KEY**
- CITY OF WOLVERHAMPTON COUNCIL/WALSALL COUNCIL LOCAL AUTHORITY DISTRICT BOUNDARY
 - PROPOSED CARRIAGEWAY
 - PROPOSED FOOTWAY, SPLITTER ISLAND OR OTHER HARD PAVED AREA
 - PROPOSED CYCLE TRACK
 - PROPOSED SHARED FOOTWAY/CYCLEWAY
 - PROPOSED VERGE / SOFT LANDSCAPING
 - PROPOSED KERBLINE
 - PROPOSED KERBLINE (NEACHELLS LANE GYRATORY)

ISSUE/REVISION		
I/R	DATE	DESCRIPTION
03	29.06.2022	LOCAL AUTHORITY AREA BOUNDARY ADDED
02	09.05.2022	DRAWING AMENDED TO SHOW PROPOSALS BEING BUILT PRIOR TO THE NEACHELLS LANE GYRATORY, CYCLE TRACK POSITIONED ON THE SOUTH SIDE OF THE CENTRAL RESERVE, LAY-BY USED FOR THE EASTBOUND PORTOBELLO ISLAND BUS STOP
01	11.04.2022	FIRST ISSUE
I/R	DATE	DESCRIPTION

DRAWING STATUS

PRELIMINARY

PROJECT NUMBER
 60640382

SHEET TITLE
 NOOSE LANE TO PORTOBELLO
 CYCLE CORRIDOR
 OPTION 2 SHEET 1 OF 2

SHEET NUMBER
 P 60640382/SK/08

This page is intentionally left blank

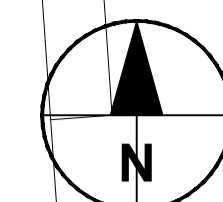
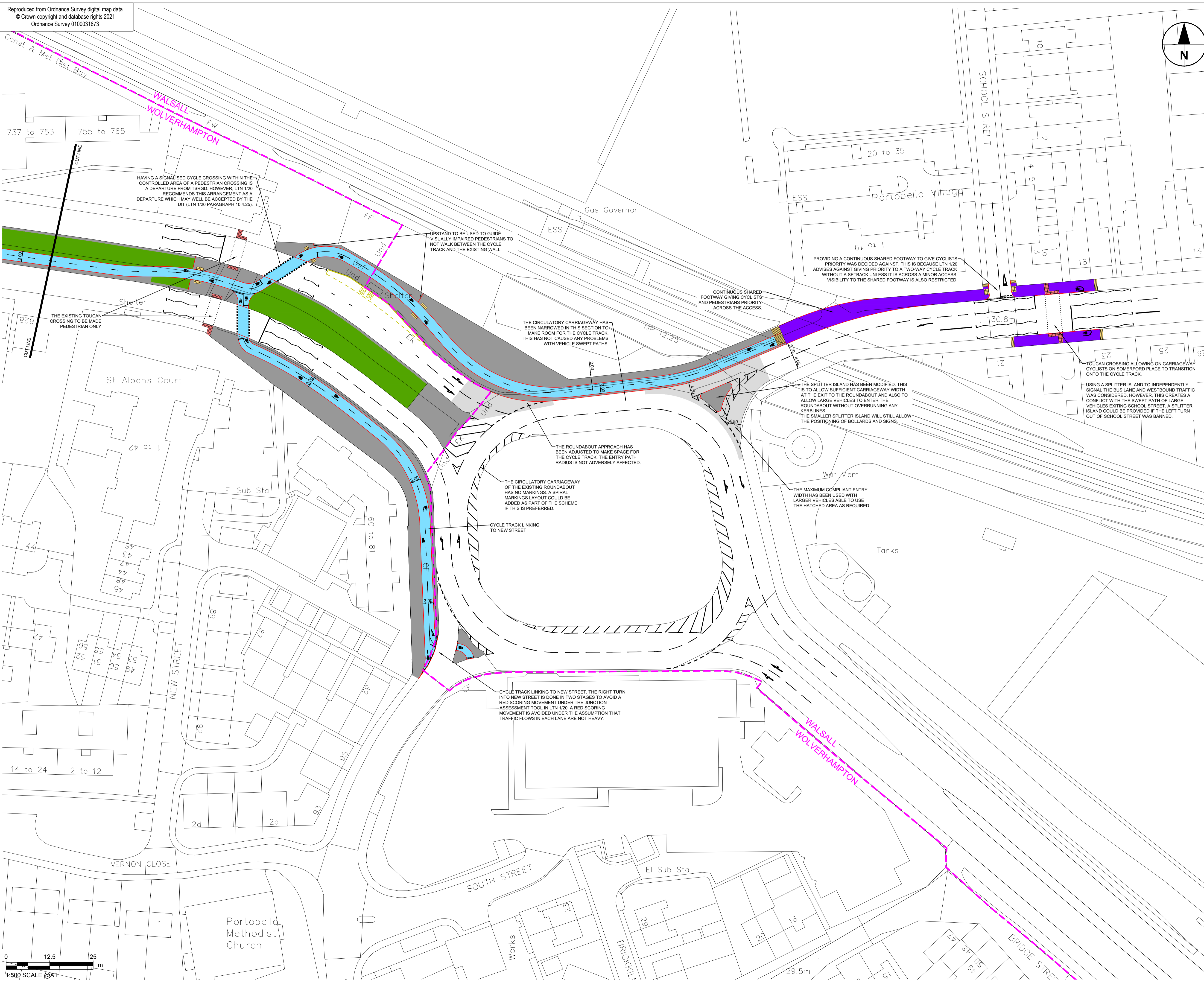

Reproduced from Ordnance Survey digital map data © Crown copyright and database rights 2021 Ordnance Survey 0100031673

This drawing has been prepared for the use of AECOM's client. It may not be used, modified, reproduced or relied upon by third parties, except as agreed by AECOM or as required by law. AECOM accepts no responsibility, and denies any liability, whatsoever, to any party that uses or relies on this drawing without consent. All measurements must be obtained from the stated dimensions.

AECOM

PROJECT
CITY EAST GATEWAY
NEACHELLS LANE
JUNCTION

CLIENT
CITY OF
WOLVERHAMPTON
COUNCIL

CONSULTANT
 AECOM Infrastructure & Environment UK Limited
 The Colmore Building
 Colmore Circus, Queensway,
 Birmingham, B4 6AT
 0121-7101100 tel
 www.aecom.com

- NOTES**
- FOR KEY LOCATION PLAN, REFER TO DRAWING 60640382/SK/05.
 - ALL DIMENSIONS ARE IN METRES.
 - THE PROPOSED DESIGN IN WALSALL COUNCIL'S LOCAL AUTHORITY DISTRICT IS FOR ILLUSTRATIVE PURPOSES ONLY AND IS SUBJECT TO WALSALL COUNCIL'S CONSIDERATION AND APPROVALS.

KEY

- CITY OF WOLVERHAMPTON COUNCIL/WALSALL COUNCIL LOCAL AUTHORITY DISTRICT BOUNDARY
- PROPOSED CARRIAGEWAY
- PROPOSED FOOTWAY, SPLITTER ISLAND OR OTHER HARD PAVED AREA
- PROPOSED CYCLE TRACK
- PROPOSED SHARED FOOTWAY/CYCLEWAY
- PROPOSED VERGE / SOFT LANDSCAPING
- PROPOSED KERBLINE

ISSUE/REVISION		
I/R	DATE	DESCRIPTION
03	29.06.2022	LOCAL AUTHORITY AREA BOUNDARY ADDED
02	09.05.2022	CYCLE TRACK POSITIONED ON THE SOUTH SIDE OF THE CENTRAL RESERVE. LAY-BY USED FOR THE EASTBOUND PORTOBELLO ISLAND BUS STOP
01	11.04.2022	FIRST ISSUE

DRAWING STATUS

PRELIMINARY

PROJECT NUMBER
60640382

SHEET TITLE
NOOSE LANE TO PORTOBELLO CYCLE CORRIDOR OPTION 2 SHEET 2 OF 2

SHEET NUMBER
P 60640382/SK/09

This page is intentionally left blank